



TRANSTEC Timing Pulleys - Taper Bush Type



## Belcon Powertrans LLP

A9, New Sonal Industrial Estate, Saki Vihar Road, Mumbai 400 072, INDIA

Tel : +91 (22) 28575318/19/20 Email : sales@belcon.co.in

## SPECIFICATIONS - JAN 2023

Ver 00 dt. 14-01-2023

### TRANSTEC Timing Pulleys - Taper Bush Type

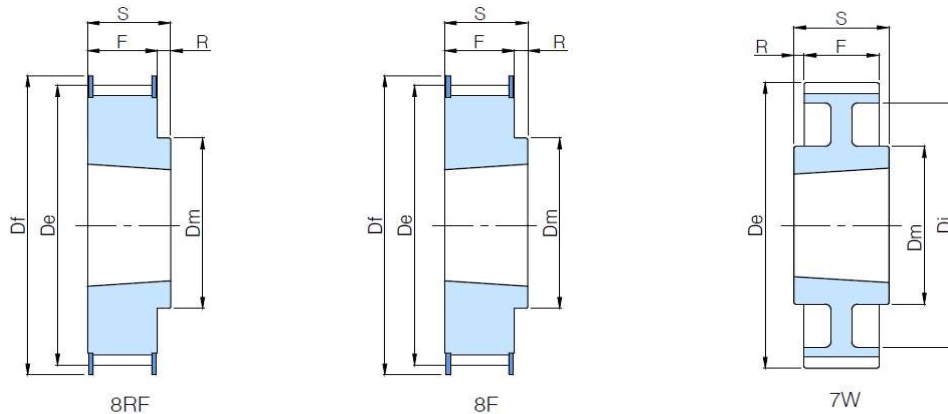

HTD 5M 15 – Pitch 5mm – for Belt Width 15mm														
FEATURES		PULLEY DESIGNATION	TYPE	TAPER BUSH	MAX. BORE	PCD	De mm	Df mm	Dm mm	Di mm	F mm	S mm	R mm	WEIGHT Kg
CARBON STEEL	WITH FLANGES	34-5M-15	8RF	1008	25	54,11	52,97	57	43	-	20,5	22	1,5	0,19
		36-5M-15	8RF	1108	28	57,30	56,16	60	44	-	20,5	22	1,5	0,20
		38-5M-15	8RF	1108	28	60,48	59,34	66	48	-	20,5	22	1,5	0,25
		40-5M-15	8F	1108	28	63,66	62,52	71	52	-	20,5	22	1,5	0,31
		44-5M-15	8F	1108	28	70,03	68,89	75	54	-	20,5	22	1,5	0,40
		48-5M-15	8F	1210	32	76,39	75,25	83	64	-	20,5	25	4,5	0,46
CAST IRON	WITH FLANGES	56-5M-15	8F	1210	32	89,13	87,99	98,5	70	-	20,5	25	4,5	0,67
		64-5M-15	8F	1210	32	101,86	100,72	106	78	-	20,5	25	4,5	0,96
		72-5M-15	8F	1610	42	114,59	113,45	119	90	-	20,5	25	4,5	1,19
		80-5M-15	8F	1610	42	127,32	126,18	135	92	-	20,5	25	4,5	1,57
	WITHOUT FLANGES	90-5M-15	7W	1610	42	143,24	142,10	-	92	126	20,5	25	2,25	1,47
		112-5M-15	7W	1610	42	178,25	177,11	-	92	162	20,5	25	2,25	1,94
		136-5M-15	7W	2012	50	216,45	215,31	-	106	199	20,5	32	5,75	3,06
		150-5M-15	7W	2012	50	238,73	237,59	-	106	222	20,5	32	5,75	3,90

## SPECIFICATIONS - JAN 2023

Ver 00 dt. 14-01-2023

### TRANSTEC Timing Pulleys - Taper Bush Type

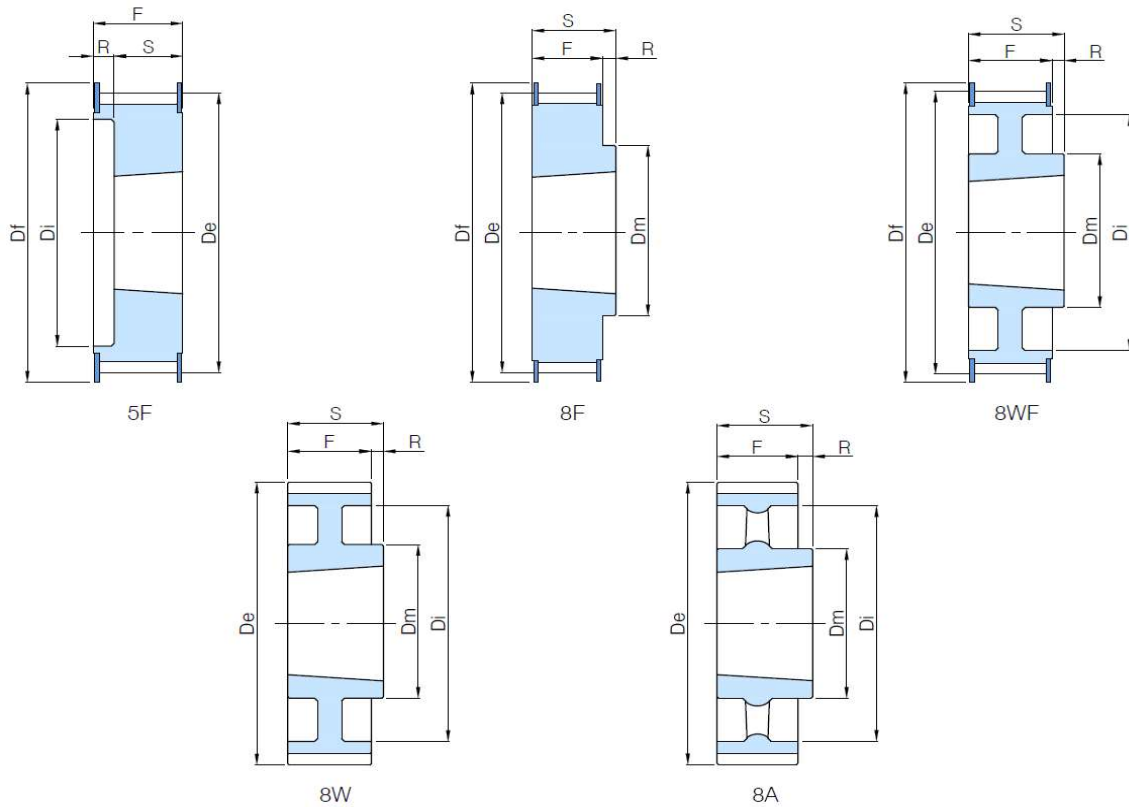

HTD 8M 20 – Pitch 8mm – for Belt Width 20mm														
FEATURES	PULLEY DESIGNATION	TYPE	TAPER BUSH	MAX. BORE	PCD	De mm	Df mm	Dm mm	Di mm	F mm	S mm	R mm	WEIGHT Kg	
CARBON STEEL	22-8M-20	5F	1008	25	56,02	54,65	60	-	41	28	22	6	0,24	
	24-8M-20	5F	1108	28	61,12	59,75	66	-	42	28	22	6	0,30	
	26-8M-20	5F	1108	28	66,21	64,84	71	-	46	28	22	6	0,36	
	28-8M-20	5F	1108	28	71,30	70,08	75	-	50	28	22	6	0,44	
CAST IRON	WITH FLANGES	30-8M-20	5F	1108	28	76,39	75,13	83	-	58	28	22	6	0,53
		32-8M-20	5F	1610	42	81,49	80,16	87	-	62	28	25	3	0,42
		34-8M-20	5F	1610	42	86,58	85,22	91	-	65	28	25	3	0,55
		36-8M-20	5F	1610	42	91,67	90,30	98,5	-	68	28	25	3	0,68
		38-8M-20	5F	1610	42	96,77	95,39	103	-	72	28	25	3	0,80
		40-8M-20	5F	1610	42	101,86	100,49	106	-	76	28	25	3	1,00
		44-8M-20	8F	2012	50	112,05	110,67	119	93	-	28	32	4	1,18
	48-8M-20	8F	2012	50	122,23	120,86	127	96	-	28	32	4	1,60	
	56-8M-20	8F	2012	50	142,60	141,23	148	110	-	28	32	4	2,40	
	64-8M-20	8WF	2012	50	162,97	161,60	168	110	137	28	32	4	2,80	
	72-8M-20	8WF	2012	50	183,35	181,97	192	110	158	28	32	4	3,40	
	WITHOUT FLANGES	80-8M-20	8W	2012	50	203,72	202,35	-	110	180	28	32	4	3,70
		90-8M-20	8A	2012	50	229,18	227,81	-	110	204	28	32	4	3,85
112-8M-20		8A	2012	50	285,21	283,83	-	110	260	28	32	4	5,50	

## SPECIFICATIONS - JAN 2023

Ver 00 dt. 14-01-2023

### TRANSTEC Timing Pulleys - Taper Bush Type

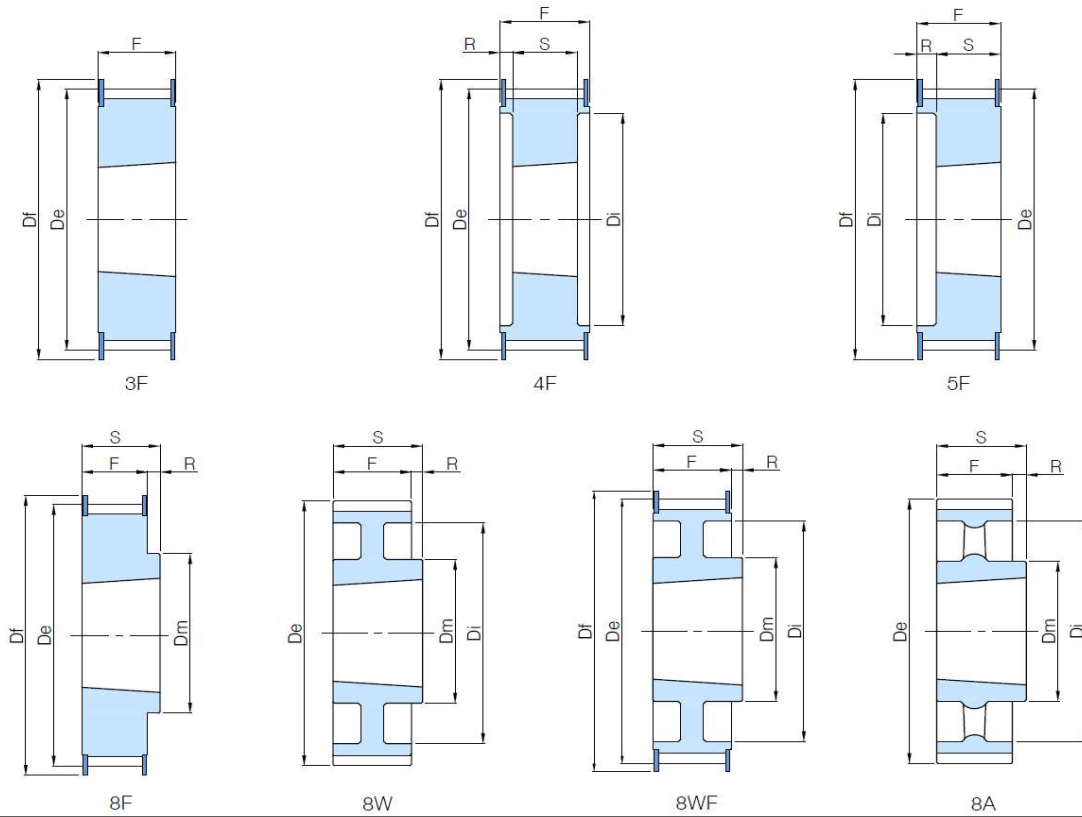

HTD 8M 30 – Pitch 8mm – for Belt Width 30mm														
FEATURES	PULLEY DESIGNATION	TYPE	TAPER BUSH	MAX. BORE	PCD	De mm	Df mm	Dm mm	Di mm	F mm	S mm	R mm	WEIGHT Kg	
CARBON STEEL	22-8M-30	5F	1008	25	56,02	54,65	60	-	41	38	22	16	0,30	
	24-8M-30	5F	1108	28	61,12	59,75	66	-	42	38	22	16	0,38	
	26-8M-30	5F	1108	28	66,21	64,84	71	-	46	38	22	16	0,45	
	28-8M-30	5F	1210	32	71,30	70,08	75	-	50	38	25	13	0,55	
CAST IRON	WITH FLANGES	30-8M-30	3F	1615	42	76,39	75;13	83	-	-	38	38	-	0,49
		32-8M-30	3F	1615	42	81,49	80,16	87	-	-	38	38	-	0,59
		34-8M-30	3F	1615	42	86,58	85,22	91	-	-	38	38	-	0,77
		36-8M-30	3F	1615	42	91,67	90,30	98,5	-	-	38	38	-	0,96
		38-8M-30	3F	1615	42	96,77	95,39	103	-	-	38	38	-	1,15
		40-8M-30	3F	1615	42	101,86	100,49	106	-	-	38	38	-	1,34
		44-8M-30	4F	2012	50	112,05	110,67	119	-	91	38	32	3	1,33
	48-8M-30	4F	2012	50	122,23	120,86	127	-	95	38	32	3	1,78	
	56-8M-30	4F	2012	50	142,60	141,23	148	-	117	38	32	3	2,75	
	64-8M-30	8F	2517	60	162,97	161,60	168	125	-	38	45	7	4,20	
	72-8M-30	8WF	2517	60	183,35	181,97	192	125	158	38	45	7	4,35	
	WITHOUT FLANGES	80-8M-30	8W	2517	60	203,72	202,35	-	125	180	38	45	7	4,75
		90-8M-30	8A	2517	60	229,18	227,81	-	125	204	38	45	7	5,25
		112-8M-30	8A	2517	60	285,21	283,83	-	125	260	38	45	7	6,50
144-8M-30		8A	2517	60	366,69	365,32	-	125	341	38	45	7	9,50	

## SPECIFICATIONS - JAN 2023

Ver 00 dt. 14-01-2023

### TRANSTEC Timing Pulleys - Taper Bush Type

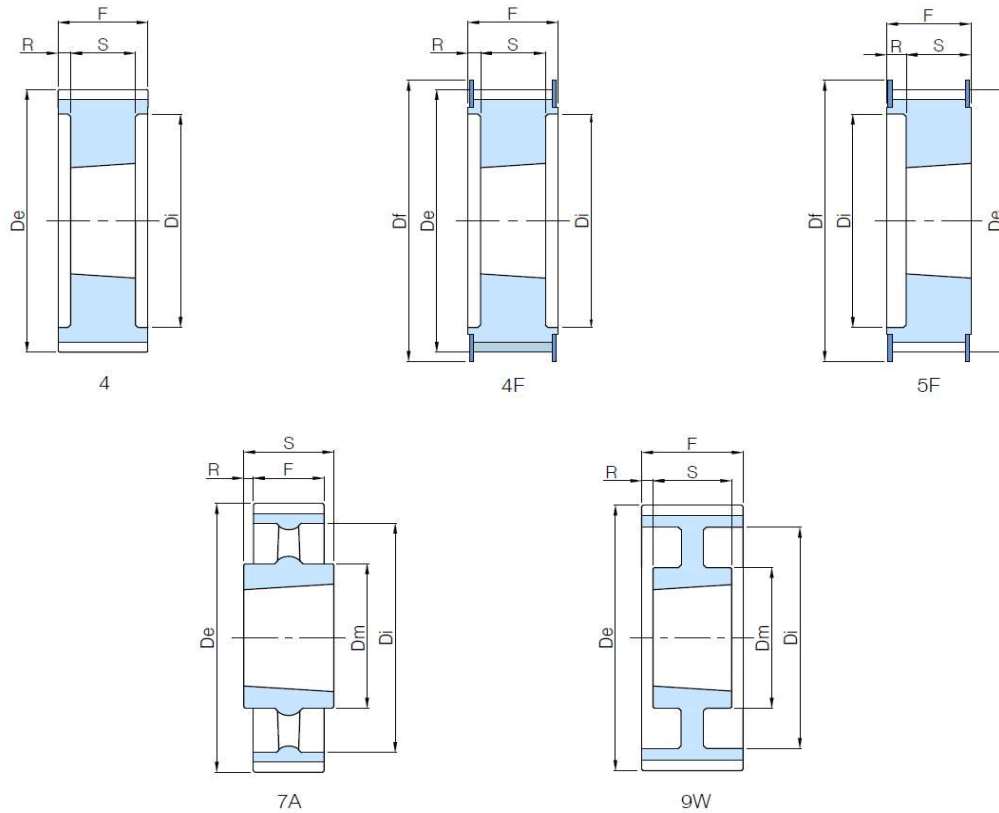

HTD 8M 50 – Pitch 8mm – for Belt Width 50mm														
FEATURES	PULLEY DESIGNATION	TYPE	TAPER BUSH	MAX. BORE	PCD	De mm	Df mm	Dm mm	Di mm	F mm	S mm	R mm	WEIGHT Kg	
CAST IRON	WITH FLANGES	28-8M-50	5F	1210	32	71,30	70,08	75	-	50	60	25	35	0,78
		30-8M-50	5F	1615	42	76,39	75,13	83	-	58	60	38	22	0,70
		32-8M-50	5F	1615	42	81,49	80,16	87	-	62	60	38	22	0,82
		34-8M-50	5F	1615	42	86,58	85,22	91	-	65	60	38	22	1,06
		36-8M-50	5F	1615	42	91,67	90,30	98,5	-	68	60	38	22	1,30
		38-8M-50	5F	1615	42	96,77	95,39	103	-	72	60	38	22	1,60
		40-8M-50	4F	2012	50	101,86	100,49	106	-	82	60	32	14	1,24
		44-8M-50	4F	2012	50	112,05	110,67	119	-	91	60	32	14	1,78
		48-8M-50	4F	2012	50	122,23	120,86	127	-	95	60	32	14	2,30
		56-8M-50	4F	2517	60	142,60	141,23	148	-	116	60	45	7,5	3,40
		64-8M-50	4F	2517	60	162,97	161,60	168	-	137	60	45	7,5	5,00
	72-8M-50	4F	2517	60	183,35	181,97	192	125	158	60	45	7,5	6,70	
	WITHOUT FLANGES	80-8M-50	4	3020	75	203,72	202,35	-	-	180	60	51	4,5	8,80
		90-8M-50	9W	3020	75	229,18	227,81	-	170	204	60	51	4,5	9,00
		112-8M-50	9W	3020	75	285,21	283,83	-	170	260	60	51	4,5	12,50
		144-8M-50	9A	3020	75	366,69	365,32	-	170	341	60	51	4,5	15,70
		168-8M-50	7A	3525	90	427,81	426,44	-	190	402	60	65	2,5	16,40
192-8M-50	7A	3525	90	488,92	487,55	-	190	460	60	65	2,5	21,80		

## SPECIFICATIONS - JAN 2023

Ver 00 dt. 14-01-2023

### TRANSTEC Timing Pulleys - Taper Bush Type

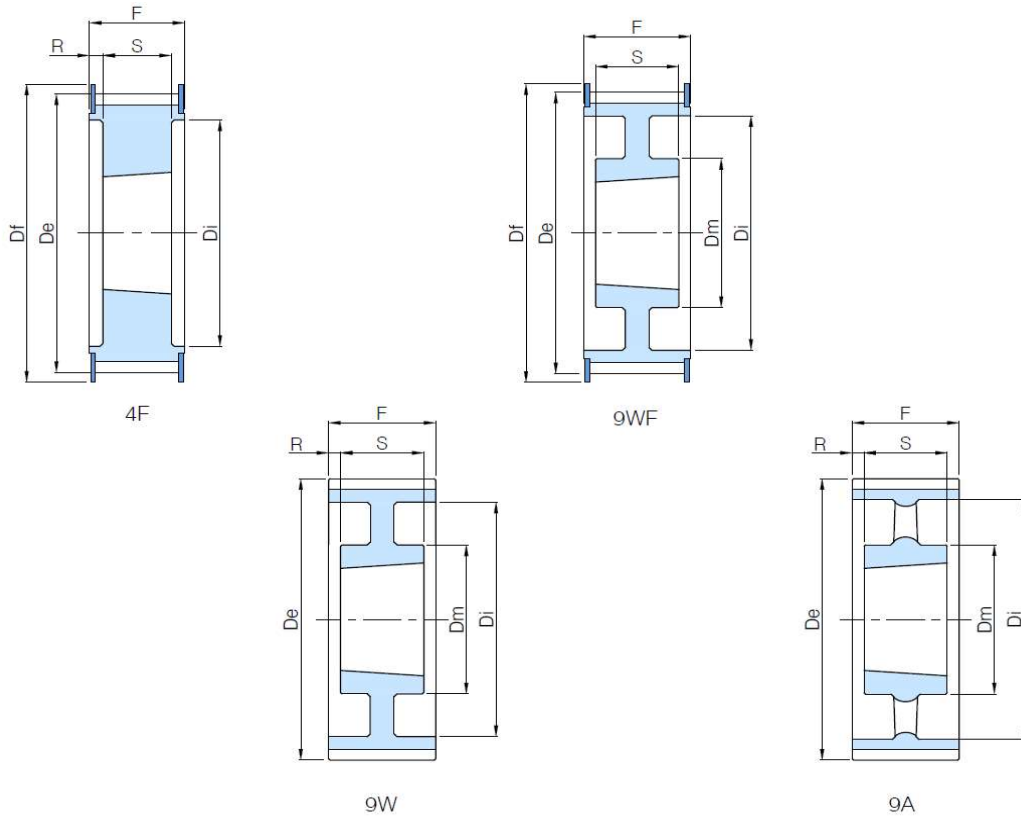

HTD 14M 40 – Pitch 14mm – for Belt Width 40mm														
FEATURES	PULLEY DESIGNATION	TYPE	TAPER BUSH	MAX. BORE	PCD	De mm	Df mm	Dm mm	Di mm	F mm	S mm	R mm	WEIGHT Kg	
CAST IRON	WITH FLANGES	28-14M-40	4F	2012	50	124,78	122,12	138	-	98	54	32	11	2,07
		29-14M-40	4F	2012	50	129,23	126,57	138	-	100	54	32	11	2,38
		30-14M-40	4F	2012	50	133,69	130,99	138	-	100	54	32	11	2,65
		32-14M-40	4F	2012	50	142,60	139,88	154	-	104	54	32	11	3,40
		34-14M-40	4F	2517	60	151,52	148,79	160	-	110	54	45	4,5	3,87
		36-14M-40	4F	2517	60	160,43	157,68	168	-	120	54	45	4,5	4,80
		38-14M-40	4F	2517	60	169,34	166,60	183	-	130	54	45	4,5	5,40
		40-14M-40	4F	2517	60	178,25	175,49	188	-	138	54	45	4,5	6,00
		44-14M-40	4F	3020	75	196,08	193,28	211	-	155	54	51	1,5	7,80
		48-14M-40	4F	3020	75	213,90	211,11	226	-	170	54	51	1,5	9,40
	56-14M-40	9WF	3020	75	249,55	246,76	265	170	208	54	51	1,5	10,80	
	64-14M-40	9WF	3020	75	285,21	282,41	296	170	239	54	51	1,5	13,40	
	WITHOUT FLANGES	72-14M-40	9W	3020	75	320,86	318,06	-	170	280	54	51	1,5	15,20
		80-14M-40	9A	3020	75	356,51	353,71	-	170	315	54	51	1,5	16,00
		90-14M-40	9A	3020	75	401,07	398,28	-	170	358	54	51	1,5	17,80
		112-14M-40	9A	3020	75	499,11	496,32	-	170	457	54	51	1,5	25,60
		144-14M-40	9A	3020	75	641,71	638,92	-	170	600	54	51	1,5	32,00
		168-14M-40	9A	3020	75	748,66	745,87	-	170	706	54	51	1,5	44,00
192-14M-40		9A	3020	75	855,62	852,82	-	170	813	54	51	1,5	49,00	

## SPECIFICATIONS - JAN 2023

Ver 00 dt. 14-01-2023

### TRANSTEC Timing Pulleys - Taper Bush Type

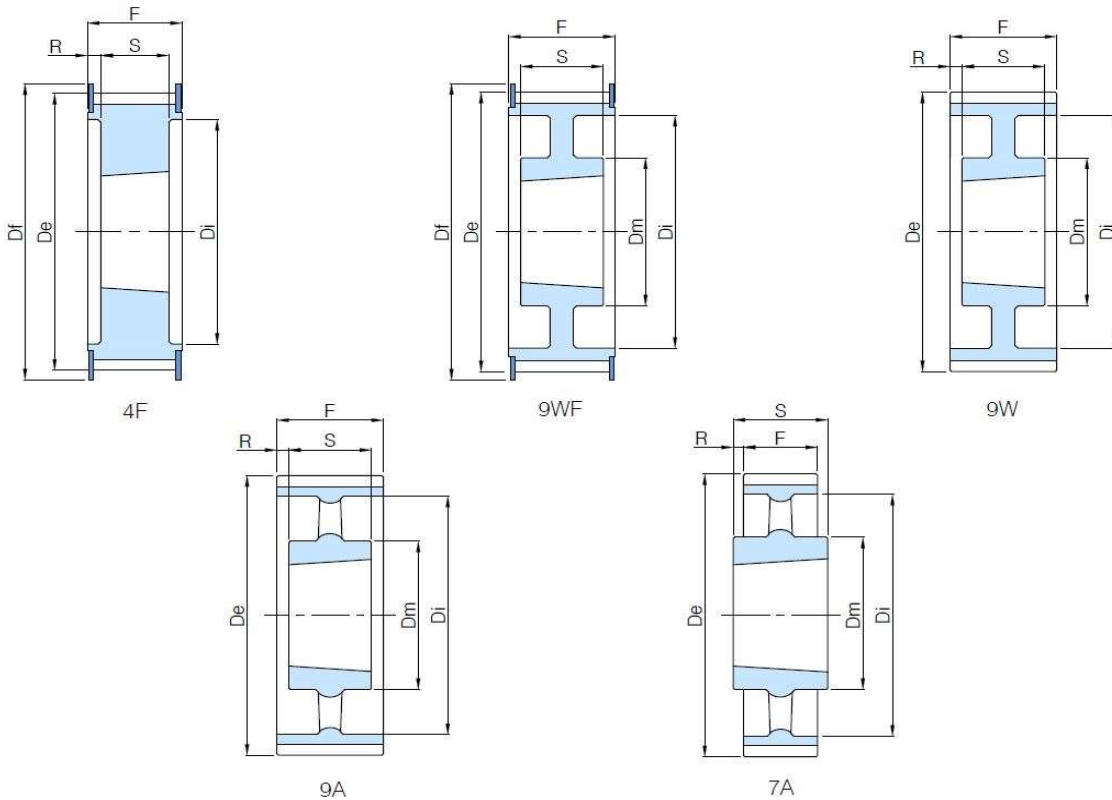

HTD 14M 55 – Pitch 14mm – for Belt Width 55mm														
FEATURES	PULLEY DESIGNATION	TYPE	TAPER BUSH	MAX. BORE	PCD	De mm	Df mm	Dm mm	Di mm	F mm	S mm	R mm	WEIGHT Kg	
CAST IRON	WITH FLANGES	28-14M-55	4F	2012	50	124,78	122,12	138	-	98	70	32	19	2,20
		29-14M-55	4F	2012	50	129,23	126,57	138	-	100	70	32	19	2,74
		30-14M-55	4F	2517	60	133,69	130,99	138	-	100	70	45	12,5	2,70
		32-14M-55	4F	2517	60	142,60	139,88	154	-	108	70	45	12,5	3,66
		34-14M-55	4F	2517	60	151,52	148,79	160	-	110	70	45	12,5	4,55
		36-14M-55	4F	2517	60	160,43	157,68	168	-	120	70	45	12,5	5,20
		38-14M-55	4F	2517	60	169,34	166,60	183	-	130	70	45	12,5	6,20
		40-14M-55	4F	2517	60	178,25	175,49	188	-	138	70	45	12,5	7,00
		44-14M-55	4F	3020	75	196,08	193,28	211	-	155	70	51	9,5	8,60
	48-14M-55	4F	3020	75	213,90	211,11	226	-	170	70	51	9,5	10,40	
	56-14M-55	9WF	3020	75	249,55	246,76	265	170	208	70	51	9,5	12,40	
	64-14M-55	9WF	3020	75	285,21	282,41	296	170	239	70	51	9,5	14,50	
	WITHOUT FLANGES	72-14M-55	9W	3020	75	320,86	318,06	-	170	280	70	51	9,5	16,20
		80-14M-55	9A	3020	75	356,51	353,71	-	170	315	70	51	9,5	17,50
		90-14M-55	9A	3020	75	401,07	398,28	-	170	358	70	51	9,5	20,10
		112-14M-55	9A	3020	75	499,11	496,32	-	170	457	70	51	9,5	28,40
		144-14M-55	9A	3020	75	641,71	638,92	-	170	600	70	51	9,5	36,20
		168-14M-55	9A	3020	75	748,66	745,87	-	170	706	70	51	9,5	49,00
192-14M-55		9A	3020	75	855,62	852,82	-	170	813	70	51	9,5	53,00	
216-14M-55		7A	3535	90	962,57	959,76	-	190	920	70	89	9,5	65,80	

## SPECIFICATIONS - JAN 2023

Ver 00 dt. 14-01-2023

### TRANSTEC Timing Pulleys - Taper Bush Type

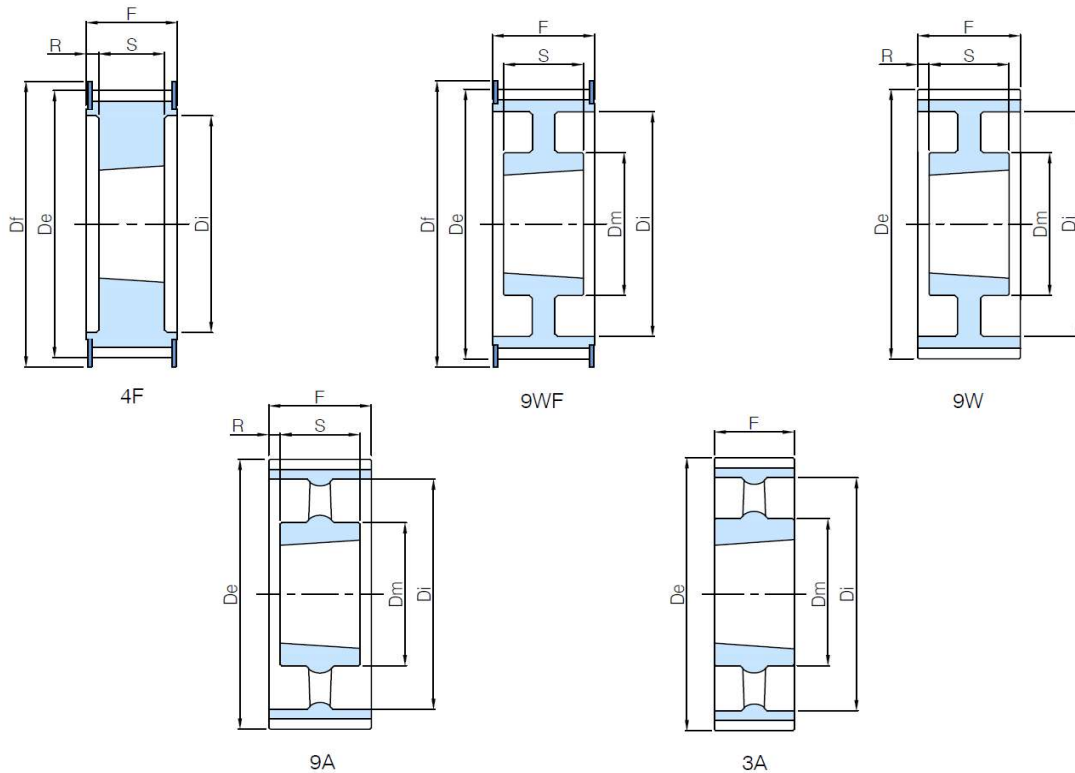

HTD 14M 85 - Pitch 14mm - for Belt Width 85mm														
FEATURES	PULLEY DESIGNATION	TYPE	TAPER BUSH	MAX. BORE	PCD	De mm	Df mm	Dm mm	Di mm	F mm	S mm	R mm	WEIGHT Kg	
CAST IRON	WITH FLANGES	28-14M-85	4F	2517	60	124,78	122,12	138	-	100	102	45	28,5	2,70
		29-14M-85	4F	2517	60	129,23	126,57	138	-	100	102	45	28,5	3,40
		30-14M-85	4F	2517	60	133,69	130,99	138	-	100	102	45	28,5	3,75
		32-14M-85	4F	2517	60	142,60	139,88	154	-	108	102	45	28,5	4,80
		34-14M-85	4F	2517	60	151,52	148,79	160	-	110	102	45	28,5	6,00
		36-14M-85	4F	3020	75	160,43	157,68	168	-	125	102	51	25,5	5,80
		38-14M-85	4F	3020	75	169,34	166,60	183	-	130	102	51	25,5	6,80
		40-14M-85	4F	3020	75	178,25	175,49	188	-	138	102	51	25,5	8,00
		44-14M-85	4F	3020	75	196,08	193,28	211	-	155	102	51	25,5	11,80
		48-14M-85	4F	3020	75	213,90	211,11	226	-	170	102	51	25,5	15,10
		56-14M-85	4F	3525	90	249,55	246,76	265	-	210	102	65	18,5	22,50
		64-14M-85	9WF	3525	90	285,21	282,41	296	190	239	102	65	18,5	26,00
	WITHOUT FLANGES	72-14M-85	9W	3525	90	320,86	318,06	-	190	280	102	65	18,5	25,50
		80-14M-85	9A	3525	90	356,51	353,71	-	190	315	102	65	18,5	29,20
		90-14M-85	9A	3525	90	401,07	398,28	-	190	358	102	65	18,5	30,80
		112-14M-85	9A	3525	90	499,11	496,32	-	190	457	102	65	18,5	39,50
		144-14M-85	9A	3525	90	641,71	638,92	-	190	600	102	65	18,5	51,00
		168-14M-85	9A	3525	90	748,66	745,87	-	190	706	102	65	18,5	61,00
		192-14M-85	3A	4040	100	855,62	852,82	-	230	813	102	102	-	86,00
216-14M-85	3A	4040	100	962,57	959,76	-	230	920	102	102	-	91,50		

Belcon reserves the rights to alter non-critical dimensions and specifications without prior intimation  
All dimensions in 'mm'

All pulleys are supplied without balancing